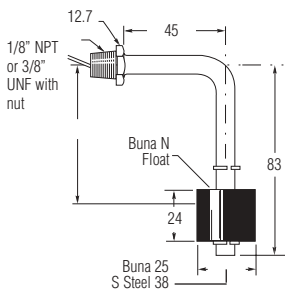

## Single level switches LS-77700, LS-1700, LS-1750E, LS-1800

**LS-77700 - Bent Stem**

These units perform in liquids with specific gravities as low as .45; switches protrude into tank less than 75mm.

**LS-1700**

Offer broad chemical compatibility for general purpose use. Also ideal for oils and water.

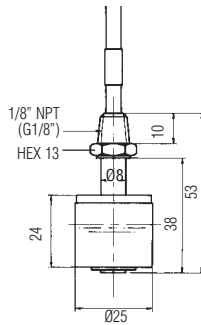
**LS-1750E**

Rugged construction suitable for most corrosive liquids, and for high temperatures and pressures.

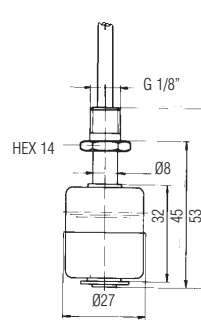
**LS-1800**

Intermediate in size, LS-1800 switches provide long life and dependability to meet a broad range of requirements.

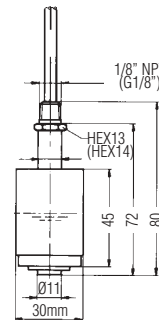
**Specifications**

	LS-77700	LS-1700	LS-1750E	LS-1800
<b>Materials</b>				
<b>Stem and mounting</b>	Brass or S Steel	Brass or S Steel	S Steel	Brass or S Steel
<b>Float</b>	S Steel or Buna N	Buna N or PTFE	S Steel	Buna N
<b>Operating pressure</b>	10bar 7 bar S Steel Float	10 Bar 70 bar PTFE Float	20 bar	10 bar
<b>Temperature</b>				
<b>-40°C to</b>	+80°C Water +110°C Oil Limited to +80°C Ambient	+80°C Water +110°C Oil +100°C PTFE	+150°C	+80°C Water +110°C Oil
<b>Depth of immersion at a density of 1</b>	Buna N: ~9mm S Steel: ~15mm	Buna N: ~9mm PTFE: ~13mm	~21mm	~24mm
<b>Minimum specific gravity of the liquid</b>	Buna N: 0.45 S Steel: 0.7	Buna N: 0.45 PTFE: 0.85	0.85	0.7
<b>Type of reed switch</b>	SPST 20 VA	SPST 50 VA	SPST 50 VA	SPST 100 VA SPDT 20 VA
<b>Electrical connection (Length approx. 1m)</b>	22 AWG 0.6m L., Teflon® Lead wires	Fly lead: AWG 20 FEP Cable: 0.34 mm <sup>2</sup> PVC	Fly lead: AWG 20 FEP Cable: 0.34 mm <sup>2</sup> PVC	Fly Lead: AWG 20 FEP Cable: 0.34 mm <sup>2</sup> PVC
<b>Mounting thread</b>	1/8" NPT 3/8" UNF with nut	1/8" NPT G 1/8	G 1/8	1/8" NPT G 1/8
<b>Protection rating</b>	IP64	IP64	IP64	IP64
<b>Weight approx</b>	150g	30g	50g	80g

- Consult factory for De-min water applications

**How to Order**

Stem, Float, Mounting Electrical Connection	LS-77700	LS-1700	LS1750E	LS-1800
Brass/Buna, NPT, cable		010-2921 NO/NC		010-2930 NO/NC 010-3011 SPDT
Brass/Buna, NPT, leads	118125	010-1701 NO/NC		013-5651 NO/NC 013-0272 SPDT
Brass/Buna, G, cable		<b>011-1700</b> NO/NC		<b>011-1800</b> NO/NC
SSteel/Buna, NPT, cable		010-2922 NO/NC		010-2931 NO/NC 010-3013
SSteel/Buna, NPT, leads		010-1702 NO/NC		013-5657 NO/NC 012-4367 SPDT
SSteel/PTFE, NPT, leads		012-6791 NO 012-7980 NC		
SSteel/PTFE, NPT, cable		010-2924 NO 010-2923 NC		
Brass/Buna, 3/8" UNF, leads	118127			
SSteel/SSteel, 3/8" UNF, leads	117716			
SSteel/SSteel, G, cable PVC			<b>011-1750</b> NO/NC	
SSteel/SSteel, G, leads			010-0340 NO/NC	
SSteel/SSteel, G, cable Silicon			010-0554 NO/NC	

 Standard Products in **bold**

SINGLE POINT

LEVEL SWITCHES

[www.gems-sensors.co.uk](http://www.gems-sensors.co.uk)